

# Data sheet - Bridge construction profiles



## **PRODUCT SPECIFICATION**

SK H2O protec bridge construction profiles according to DIN 7865, part 2 are permanently flexible sealing profiles made of elastomer, SBR or EPDM, that are used to seal joints in waterproof concrete structures with high water pressures.

## **Characteristics / Advantages**

- high tensile strength and elongation at break
- high permanent flexibility and high-load bearing capacity
- suitable for water pressure and large settlements
- resistant to all natural media acting aggressively to concrete
- resistant to a wide range of chemical substances (tests required for each additional specific situation)
- resistant to bitumen
- supply of systems for easy handling on site
- vulcanizable by using butt joints on site

## **Application**

- cornice sealing
- longitudinal joint sealing for bridge constructions

### Typical structures

- bridges, trough and bridge constructions
- rail tunnels and road tunnels

# Data sheet - Bridge construction profiles



## **Standards / Directives**

- DIN 18197
- DIN 7865, part 2
- WU- Directives DAfStb
- ZTV-ING, Riz-Ing
- Vulcanizing instructions

## **Test certificate / Approvals**

- latest manufacturer's test certificate
- certificate of conformity - DIN 7865
- external monitoring by MPA NRW
- internal monitoring

## **PRODUCT DATA**

### **Material**

- SBR elastomer (styrene butadiene rubber)
- EPDM elastomer (ethylene-propylene-diene monomer)

### **Colour**

- black

### **Packaging**

- supplied as standard rolls (25 m), pre-cut parts and systems

# Data sheet - Bridge construction profiles



---

## MECHANICAL PROPERTIES according to DIN 7865, part 2

---

<b>Shore A hardness</b>	62 ± 5
<b>Tear strength</b>	≥ 10 MPa
<b>Elongation at break</b>	≥ 380 %
<b>Compression set</b>	168h / 23°C ≤ 20% 24h / 70°C ≤ 35%
<b>Tear propagation resistance</b>	≥ 8 kN/m
<b>Performance after heat ageing</b>	Shore A hardness change ≤ 8 Tear strength ≥ 9 MPa Elongation at break ≥ 300%
<b>Low temperature performance</b>	≤ 90 Shore A
<b>Tension set</b>	≤ 20%
<b>Performance after conditioning in hot bitumen</b>	Residual deformation < 20% Tear strength ≥ 7 MPa Elongation at break ≥ 300%
<b>Performance after ozone ageing</b>	No cracks

---

# Data sheet - Bridge construction profiles



GK 450

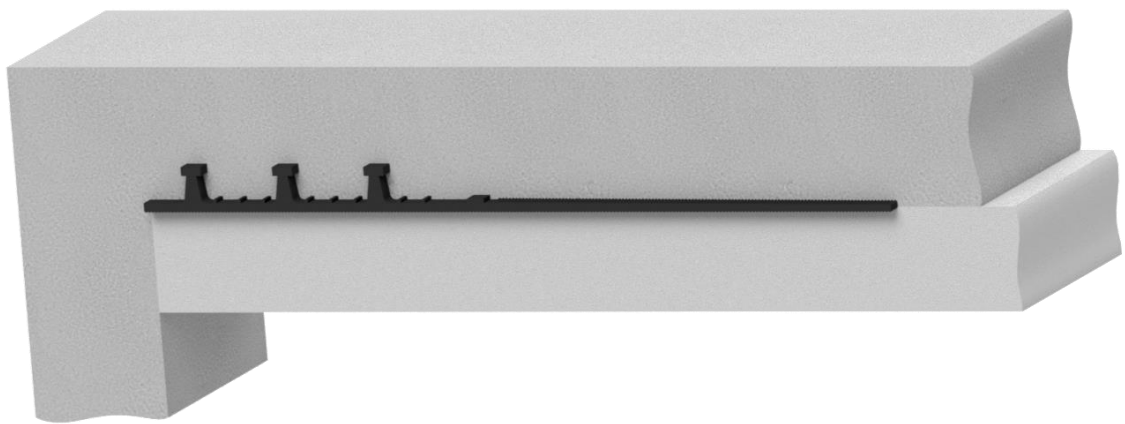
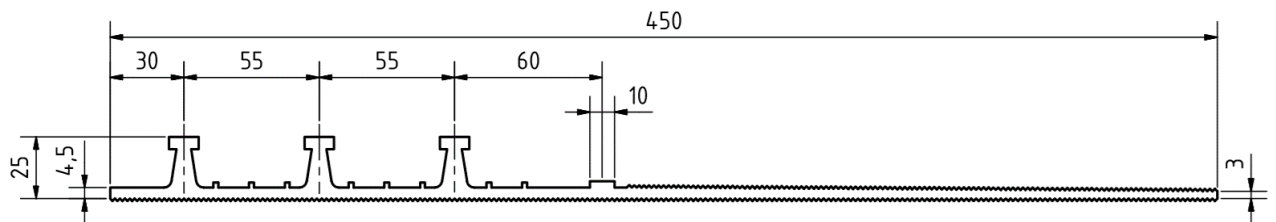

D 2511

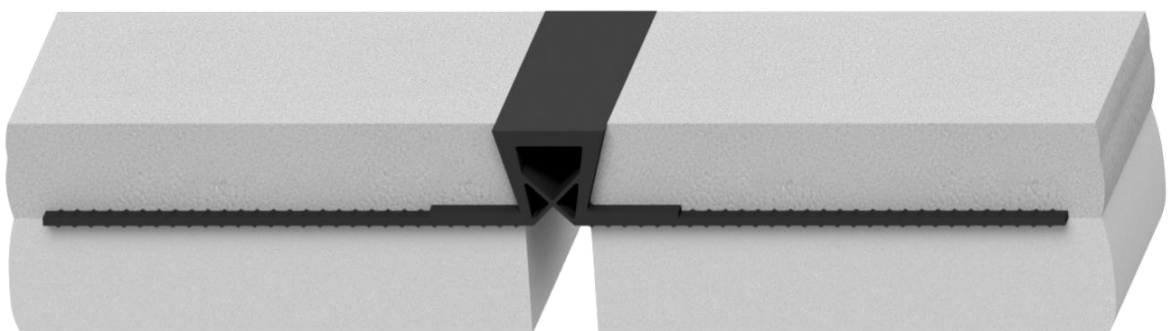
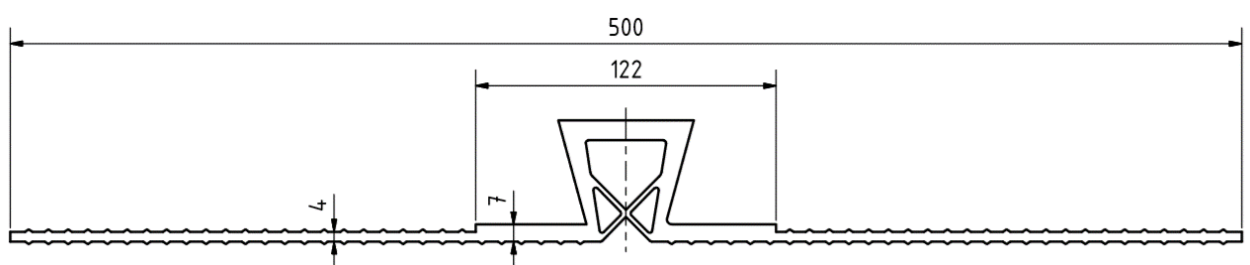

All dimensions in mm